

FLOOR PLANS CAPACITY CHARTS

THE WESTIN
BIRMINGHAM



MEETING SPACE OVERVIEW

2221 Richard Arrington, Jr. Boulevard North
Birmingham, Alabama 35203
T 205.307.3600 F 205.307.3605
E westinbirmingham@starwoodhotels.com
westinbirmingham.com

THE WESTIN
BIRMINGHAM

SECOND FLOOR

1. HOSPITALITY A
2. HOSPITALITY B
3. AZALEA
4. MAGNOLIA
5. ORCHID BOARDROOM
6. POOL TERRACE
7. FERN

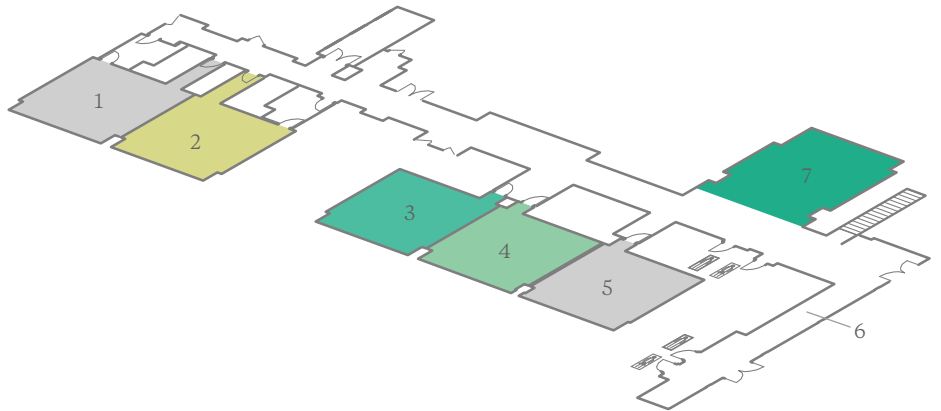

LOBBY LEVEL

1. WESTIN BALLROOM
2. CAMELIA
3. TODD ENGLISH P.U.B.

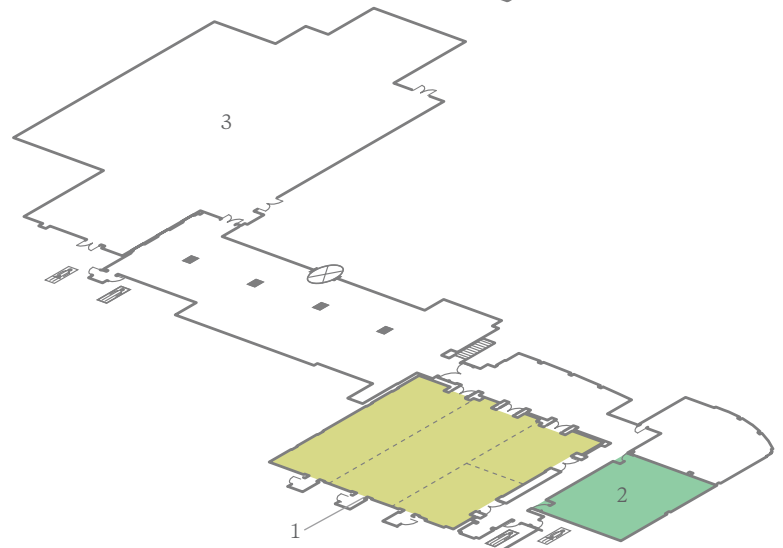

ROOMS AT A GLANCE

TOTAL GUEST ROOMS	294
TOTAL MEETING ROOMS	12
LARGEST MEETING ROOM CAPACITY	360
LARGEST MEETING ROOM SIZE	358 m ² / 3,853 ft ²

Additional spaces for meetings and events, not displayed here, may also be available. Contact your hotel representative for more information.

This document contains approximate measurements and square footage that are for illustrative purposes only. We cannot guarantee the floor plan accuracy or completeness, therefore encourage you to review the space to make sure it is suitable for your event.

MEETING SPACE SECOND FLOOR

2221 Richard Arrington, Jr. Boulevard North
Birmingham, Alabama 35203
T 205.307.3600 F 205.307.3605
E westinbirmingham@starwoodhotels.com
westinbirmingham.com

THE WESTIN
BIRMINGHAM

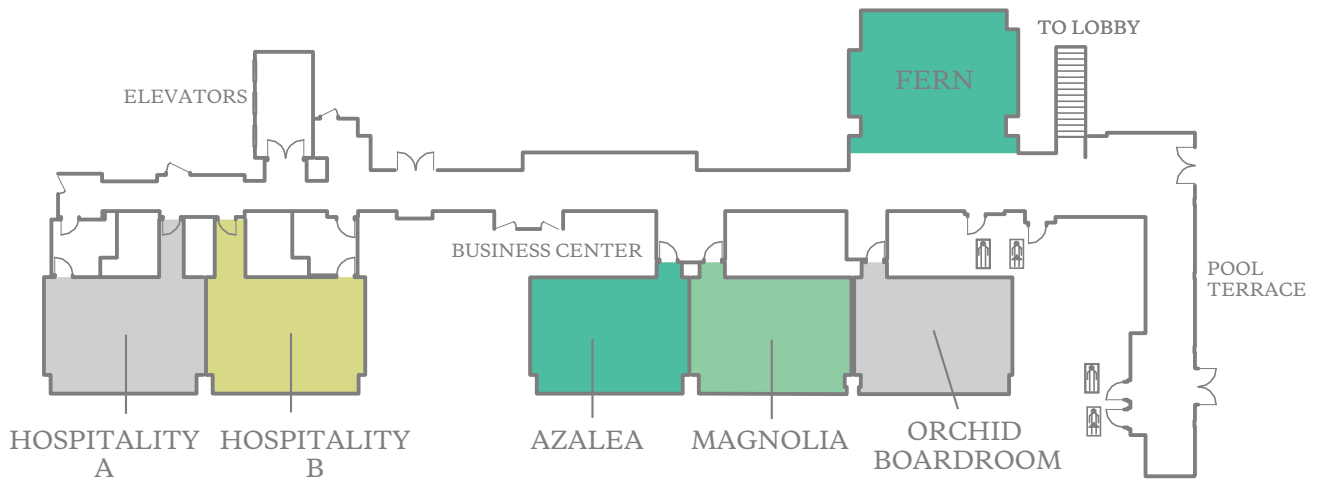

	DIMENSIONS	AREA (SQ. FT.)	MAX CEILING HEIGHT	THEATER	THEATER CHEVRON	CLASSROOM	CLASSROOM CHEVRON	BANQUET	BANQUET CHEVRON	CONFERENCE	U-SHAPE	HOLLOW SQ.	RECEPTION
■ AZALEA	22' X 27'	519	8.7'	30	—	18	—	20	—	18	17	22	54
■ FERN	42' X 58'	1,343	7.9'	—	—	—	—	—	—	—	—	—	75
■ HOSPITALITY A	29' X 27'	549	8.6'	—	—	—	—	—	—	—	—	—	57
■ HOSPITALITY B	29' X 27'	540	8.6'	—	—	—	—	—	—	—	—	—	56
■ MAGNOLIA	22' X 27'	519	8.6'	30	—	18	—	20	—	18	17	22	54
■ ORCHID BOARDROOM	22' X 26'	508	8.7'	—	—	—	—	—	—	10	—	—	53
POOL TERRACE	—	—	—	—	—	—	—	—	—	—	—	—	50

This document contains approximate measurements and square footage that are for illustrative purposes only. We cannot guarantee the floor plan accuracy or completeness, therefore encourage you to review the space to make sure it is suitable for your event.

MEETING SPACE LOBBY LEVEL

2221 Richard Arrington, Jr. Boulevard North
Birmingham, Alabama 35203
T 205.307.3600 F 205.307.3605
E westinbirmingham@starwoodhotels.com
westinbirmingham.com

THE WESTIN
BIRMINGHAM

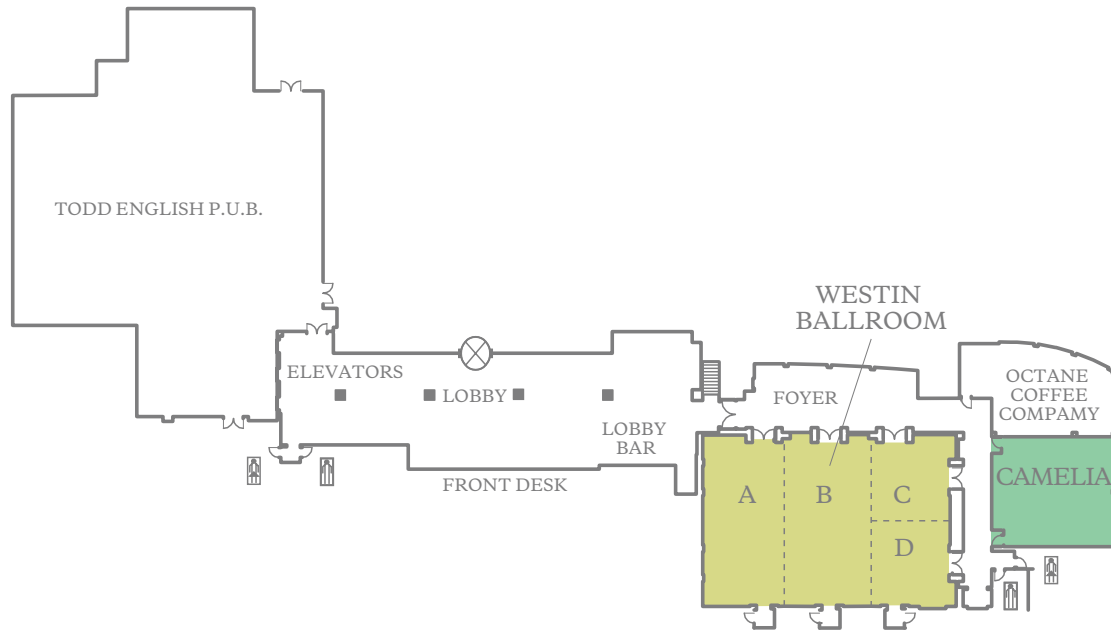

	DIMENSIONS	AREA (SQ. FT.)	MAX CEILING HEIGHT	THEATER	THEATER CHEVRON	CLASSROOM	CLASSROOM CHEVRON	BANQUET	BANQUET CHEVRON	CONFERENCE	U-SHAPE	HOLLOW SQ.	RECEPTION
■ CAMELIA	36' X 33'	1,177	10.9'	98	—	60	—	70	—	28	30	40	123
■ WESTIN BALLROOM	58' X 77'	3,947	14.4'	340	—	216	—	240	—	—	—	—	415
■ BALLROOM FOYER	74' X 83'	1,883	14.3'	—	—	—	—	—	—	—	—	—	198
■ WESTIN BALLROOM A	58' X 25'	1,316	14.4'	110	—	54	—	80	—	42	46	52	138
■ WESTIN BALLROOM A - B	58' X 52'	2,691	14.4'	216	—	108	—	160	—	61	82	82	283
■ WESTIN BALLROOM B	58' X 26'	1,375	14.4'	110	—	54	—	80	—	42	46	46	144
■ WESTIN BALLROOM B - D	58' X 52'	2,631	14.4'	209	—	108	—	160	—	61	82	82	276
■ WESTIN BALLROOM C	26' X 26'	600	14.4'	48	—	24	—	40	—	18	20	28	63
■ WESTIN BALLROOM C-D	58' X 26'	1,256	14.4'	110	—	54	—	80	—	42	46	52	132
■ WESTIN BALLROOM D	32' X 26'	656	14.4'	48	—	24	—	40	—	18	22	28	69

This document contains approximate measurements and square footage that are for illustrative purposes only. We cannot guarantee the floor plan accuracy or completeness, therefore encourage you to review the space to make sure it is suitable for your event.



2221 Richard Arrington, Jr. Boulevard North
Birmingham, Alabama 35203
T 205.307.3600 F 205.307.3605
E westinbirmingham@starwoodhotels.com
westinbirmingham.com

THE WESTIN
BIRMINGHAM